

SABRE AIRCRAFT TOOLS

Flush Squeezer Sets

Part No.	"L" Dimension inch/mm
SM 210	1/8" (3.18mm)
SM 211	1/4" (6.35mm)
SM 212	3/8" (9.53mm)
SM 213	1/2" (12.7mm)
SM 214	5/8" (15.88mm)
SM 215	3/4" (19.05mm)
SM 216	7/8" (22.23mm)
SM 217	1" (25.4mm)
SM 218	Specify

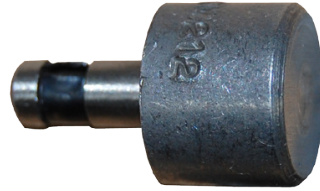

Can be furnished with 3/8" body diameter

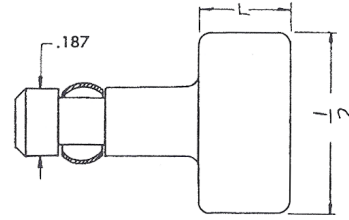

SPACER SHIMS

Part No.	Shank Size	"A" +010 -000
SMS-0	.187	1/64
SMS-1	.187	1/32
SMS-2	.187	1/16

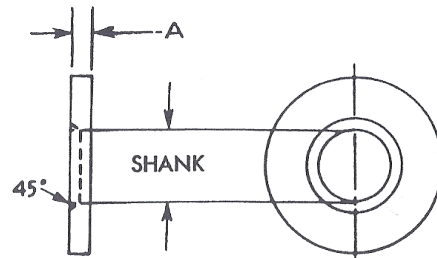

RIVET STYLE CHART								
AN435 Button	AN430 Round	AN455 Brazier	AN456 Mod. Brazier	AN470 Universal	AN442 Flat	BACR 15FT Briles Boeing	AN426 Countersunk	AN450 Semi-Tubular

Safety Precaution: Read and follow all safety and operating instructions.

WARNING: Face and eye protections must be worn while operating power tools, per ANSI B186.1

Products and specifications subject to change without prior notice.



www.sabretools.com
info@sabretools.com